

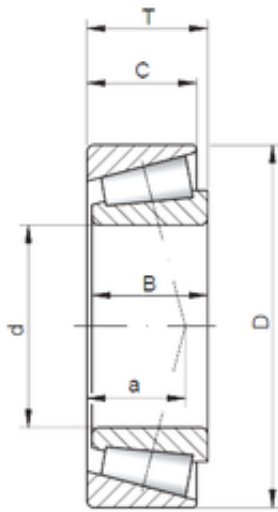

Timken MANUFACTURING (THAILAND)CO.,LTD.



19,05 mm x 49,225 mm x 19,05 mm ISO
09067/09196 tapered roller bearings

Bearing No. 09067/09196

Size	19.05x49.225x21.209 mm
Bore Diameter	19,05 mm
Outer Diameter	49,225 mm
Width	21,209 mm
d	19,05 mm
D	49,225 mm
T	21,209 mm
B	19,05 mm
C	17,462 mm
a	7,4 mm

09067/09196 Bearing 2D drawings and 3D CAD models