

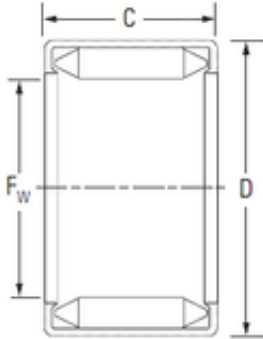

KOYO BT166 needle roller bearings



Bearing No. BT166

Size	25.4x31.75x9.52 mm
Bore Diameter	25,4 mm
Outer Diameter	31,75 mm
Width	9,52 mm
Fw	25,4 mm
D	31,75 mm
C	9,52 mm
Weight	0,014 Kg
Basic dynamic load rating (C)	6,5 kN
Basic static load rating (C0)	9,1 kN
(Grease) Lubrication Speed	8500 r/min

BT166 Bearing 2D drawings and 3D CAD models